



401 South Grand Ave., Santa Ana, CA 92705 USA
 Tel: 714-550-6070 Fax: 714-550-9661 www.twobros.com

BMW R1100S Dual Slip-On Exhaust System



Parts List

QTY.	DESCRIPTION	PART NUMBER
1	10" RIGHT SIDE EXIT MUFFLER	VARIES BY MODEL
1	10" LEFT SIDE EXIT MUFFLER	VARIES BY MODEL
2	MUFFLER CLAMPS WITH RUBBER LINER	VARIES BY MODEL
1	SLIP ON "Y" CONNECTOR	005-8504N
1	LICENSE PLATE HOLDER	005-8504L
1	SET OF LIGHTED BOLTS	005-8504LT
1	FLAT BRACKET	005-8504B
1	18MM SPACER	005-S-18
1	MUFFLER HANGER BRACKET	005-8504M
1	8X40MM SOCKET HEAD CAP SCREW	NA
3	8X20MM SOCKET HEAD CAP SCREW	NA
3	8MM NYLON LOCK NUTS	NA
2	8MM FLANGE NUTS	NA
4	8MM WASHERS	NA
4	75MM SPRINGS	005-S75
2	HITCH PINS	NA
1	HIGH TEMP SILICONE SEALANT	031-P22072
2	TBR 7" SCRIPT DECALS	015-10197



IMPORTANT - PLEASE READ CAREFULLY

We recommend that this performance exhaust system be installed by a qualified motorcycle technician. If you have any doubts as to your ability to install this exhaust system, please consult with your local motorcycle dealer. Read all instructions first before starting installation. Make sure the motorcycle and exhaust system are completely cool before starting the installation. Also, make sure the bike is secure on the sidestand or ideally a rear service stand during installation. Be sure to save all stock exhaust components for possible use later.

Installation Instructions

1. Make sure the bike is completely cool before starting the installation. Make sure the bike is secure on the sidestand or ideally a rear service stand.
2. Remove the seat, rear side panels and number plate.
3. Remove the stock canister assembly. **Do not remove the header pipes or catalytic converter.**
4. Install the slip-on connector onto the stock collector reusing the BMW clamp. **Leave loose for now.**
5. Install the canister hanger bracket onto the two horizontal posts that supported the stock mufflers (ref. illustration). It may be necessary to lightly tap the bracket into place with a hammer. Make sure the hanger bracket is **fully engaged** onto the posts and that there is at least 1/4" of post extending past the new hanger bracket. Drill one 2.5mm hole through each post and install the supplied stainless steel hitch pin clips. These clips will prevent the mufflers from sliding back on the hanger posts.
6. Place a bead of the hi-temp sealant on the outside edge of the slip-on connector that go into the canisters. Slide the canisters onto the end of the s-bend connector. Wipe off the excess sealant that will squeeze out. Rotate the canisters to the proper orientation and install the springs.
7. Assemble the canister clamps and hardware (ref. illustration). **Leave loose for now.**
8. Install the slip-on connector/canister assembly onto the collector. Attach the slip-on connector/canister assembly to the hanger bracket using the 8mm x 40mm bolt. Carefully align all pipes, canisters and hardware. When everything is in place, tighten all hardware and clamps. Don't forget to tighten the front head pipe nuts, crossover pipe clamp and O² sensor. Connector the license plate lights to the wiring harness.
9. Before you run the bike, clean off all fingerprints and dirt, as any oily residue will etch the metal and become somewhat permanent when the system gets hot. Run the bike and enjoy. It is normal for some white smoke to appear the first time you start the bike. This is packing/manufacturing oil from inside the pipe burning off. Check for gaps or leaks. If you find a leak, a little high temperature silicon sealant should fix it. After 50 to 100 miles, recheck all fasteners for tightness.

OE Exhaust Detail

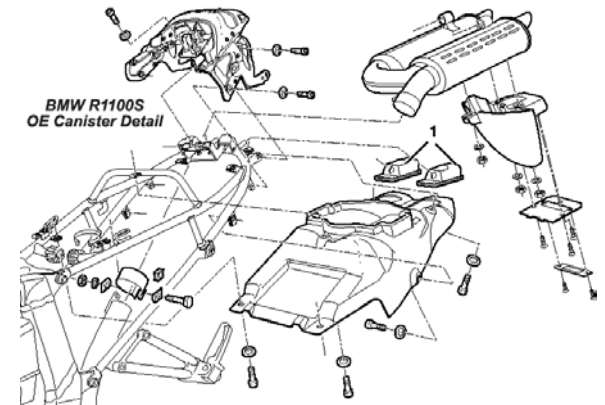

License Plate Hanger Detail

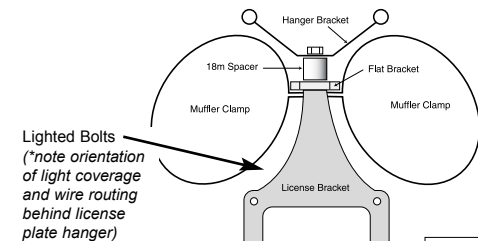
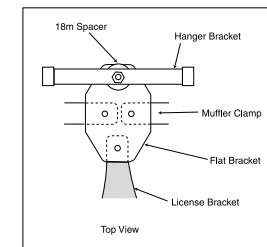

Lighted Bolts
 ("note orientation of light coverage and wire routing behind license plate hanger")

View from rear of bike

BMW R1100S
 Special Hardware for